



---

**CERTIFICATE OF APPROVAL**  
**No CF 857**

---

This is to certify that, in accordance with  
TS00 General Requirements for Certification of Fire Protection Products  
The undermentioned products of

**TUFWELL GLASS**

Church Court, Church Road, Crawley, RH11 0PQ  
Tel: 01293 533533 Fax: 01293 611511

Have been assessed against the requirements of the Technical Schedule(s)  
denoted below and are approved for use subject to the conditions  
appended hereto:

---

**CERTIFIED PRODUCT**

**'PYRO-TUF'**  
Fire Resisting Glass

**TECHNICAL SCHEDULE**

**TS 25 Fire Resistant Glass,  
Glazing Systems and Materials**

Signed and sealed for and on behalf of CERTIFIRE

A handwritten signature in black ink, appearing to be "Sir Ken Knight".

Sir Ken Knight  
Chairman - Management Council

Issued: 16 May 2011  
Valid to: 15 May 2016

Page 1 of 4





**CERTIFICATE No CF 857  
TUFWELL GLASS**

**PYRO-TUF Fire Resisting Glass**

This Certificate of Approval relates to the fire resistance of SIG Glazing Services 'PYRO-TUF' glass products when used in the following applications, as defined in BS 476: Part 22: 1987 subject to the undermentioned conditions.

Application	Fire Resistance Performance (mins)		Page No.
	Integrity	Insulation	
Timber based doorsets	30	0	3

This product is approved on the basis of:

- a) Initial type testing
- b) A design appraisal against TS25
- d) Audit testing
- e) Inspection and surveillance of factory production control
- f) Certification of quality systems to ISO 9001: 2008

This Certificate of Approval must be read in conjunction with CERTIFIRE Technical Schedule TS25, Fire Resistant Glass, Glazing Systems and Materials.

**General Requirements**

The bead edge cover to each pane shall be 8 mm and edge clearance shall be no less than 3 mm per edge (7 mm to head if expansion is not possible at the bottom edge) – see diagram for details.

There is no restriction to the direction of exposure for the glass i.e. the glass is symmetrical.

**CERTIFICATE No CF 857**  
**TUFWELL GLASS**

**PYRO-TUF glass in timber based doorsets for periods of 30 minutes integrity**

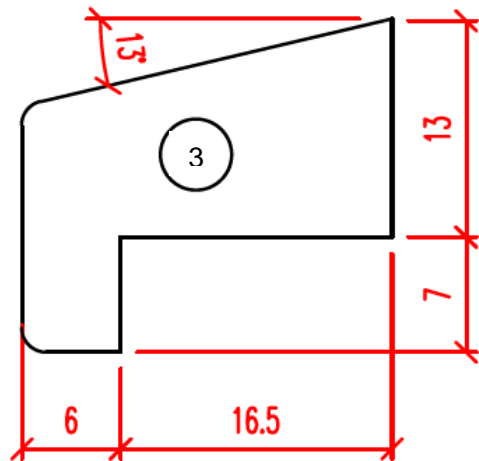
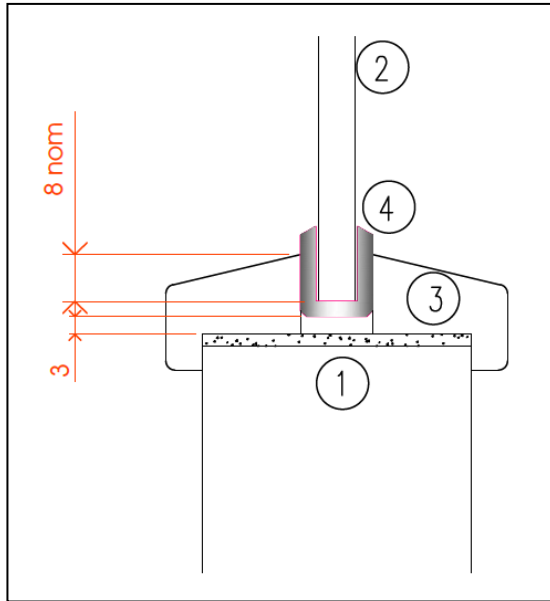

Key:

1. 2 mm thick Palusol Liner
2. PYRO-TUF glass, 6 mm thick
3. Glazing bead, Hardwood (min. density 530kg/m<sup>3</sup>), pin fixed perpendicular to bead splay (16 gauge x 50 mm long) at nominal 250 mm centres
4. System 36/6 glazing channel by Lorient Polyproducts Ltd.

The doorset into which the glazed aperture is fitted shall be CERTIFIRE approved and have test evidence for the inclusion of apertures of the proposed dimensions.

This Certificate of Approval relates to the sizes of PYRO-TUF Glass shown in Figure 1 below, when used in conjunction with the above system.

**CERTIFICATE No CF 857**  
**TUFWELL GLASS**

**PYRO-TUF glass in timber based doorsets for periods of 30 minutes integrity**

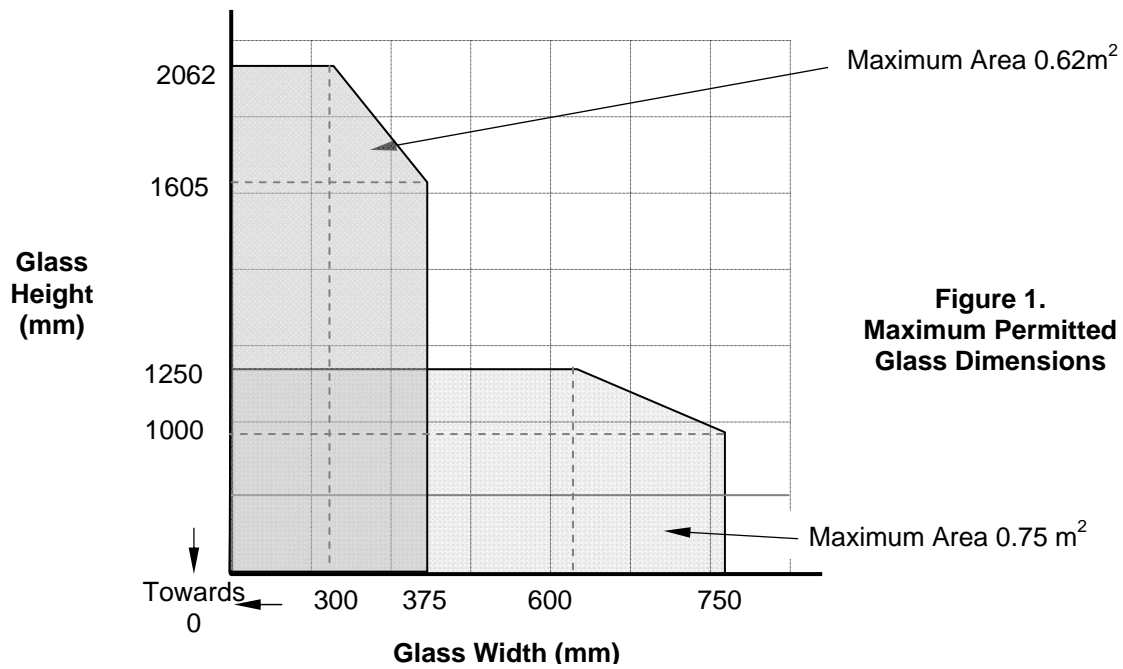

Circular Apertures may also be provided with a maximum diameter of 564 mm (0.25 m<sup>2</sup>).